



AC2800 Wireless MU-MIMO VDSL/ADSL Modem Router

Wave 2 Wi-Fi to Connect
Faster on More Devices



Archer VR2800

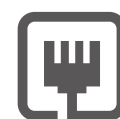

VDSL/ADSL/Fiber/
Cable Compatible



MU-MIMO
Technology



1GHz Dual-
Core CPU



NitroQAM™
(1024QAM)



Beamforming

Highlights

MU-MIMO: Efficient Wi-Fi for Every Device

MU-MIMO technology serves up to four devices at once, reducing wait time, increasing Wi-Fi throughput for every device, and making each stream more efficient.



Traditional Router
Sends data to one device at a time

Archer VR2800
Simultaneously sends data to multiple devices

NitroQAM™ and 4-Stream

The 5GHz band is enhanced with NitroQAM™ (1024QAM), boosting Wi-Fi speeds by 25% to significantly improve performance. 4-Stream technology runs 4 data streams on 5GHz band to increase overall speed by 33% compared to standard routers.



TP-Link AC2800 Wireless MU-MIMO VDSL/ADSL Modem Router **Archer VR2800**

Highlights

Versatile Connectivity

As a powerful DSL modem router, the Archer VR2800 supports super fast VDSL or ADSL broadband of up to 100Mbps, as well a variety of other connection types. The LAN/WAN port accepts connections from Cable Modem or Fiber Modem, and both of the two USB 3.0 ports support 3G/4G dongle connections for a perfect main or backup internet connection.

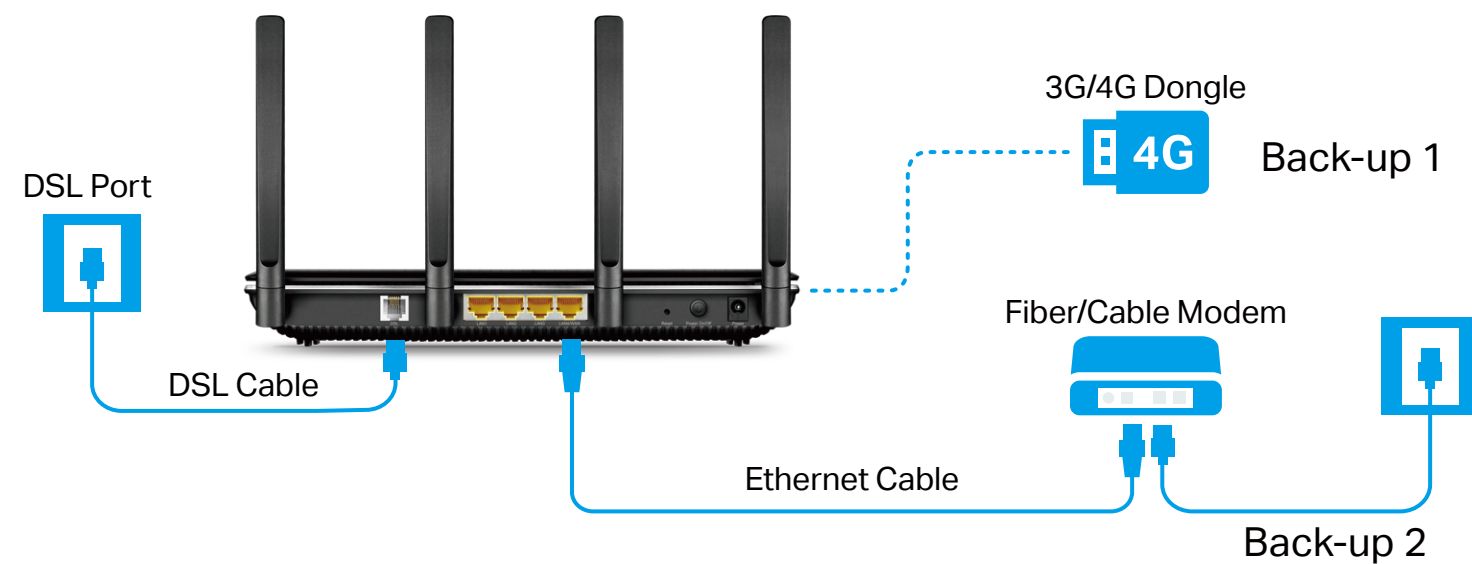

1 GHz Dual-Core CPU + 2 Co-Processors

The Archer VR2800 adds a dedicated processor for each band to manage Wi-Fi traffic, freeing up the router's 1GHz dual-core CPU to tackle more consuming tasks.

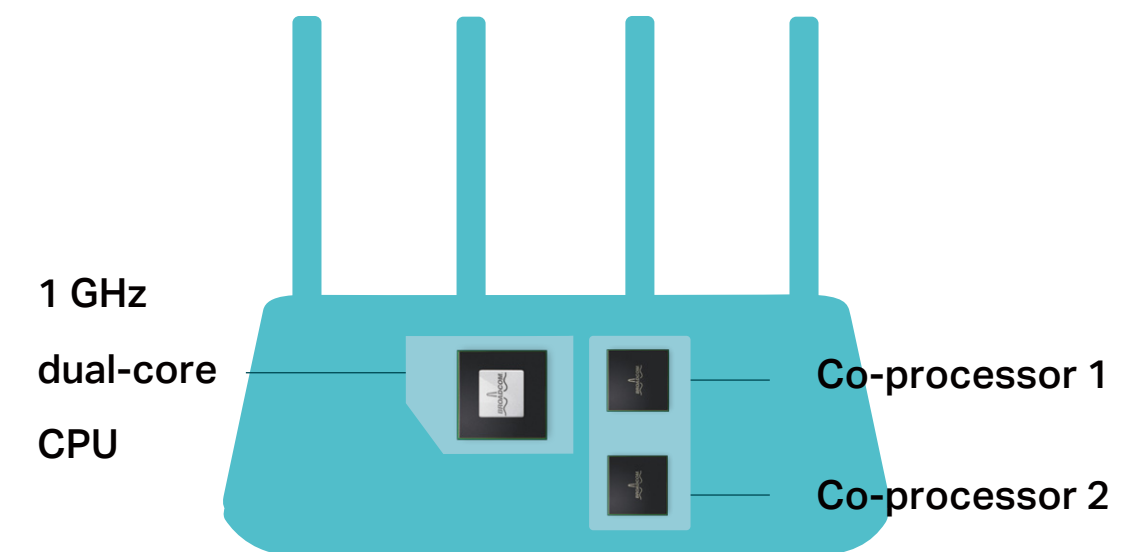

TP-Link AC2800 Wireless MU-MIMO VDSL/ADSL Modem Router Archer VR2800

Features



Speed

- **Ultimate Wireless Speed** – Combined wireless speeds of up to 600 Mbps (over 2.4GHz) and 2167 Mbps (over 5GHz)
- **NitroQAM Technology** – Uses NitroQAM (1024 QAM) modulation scheme for higher data throughput, boosting wireless speeds by up to 25%
- **MU-MIMO Technology** – Simultaneously exchange data with several devices, achieving speeds which are 4x faster than standard AC routers
- **802.11 ac** – Provides a data transfer rate 3 times faster than 802.11n for each stream
- **Dual-core CPU** – 1GHz dual-core CPU and 2 co-processors make multi-tasking easy and boost data transfer rate

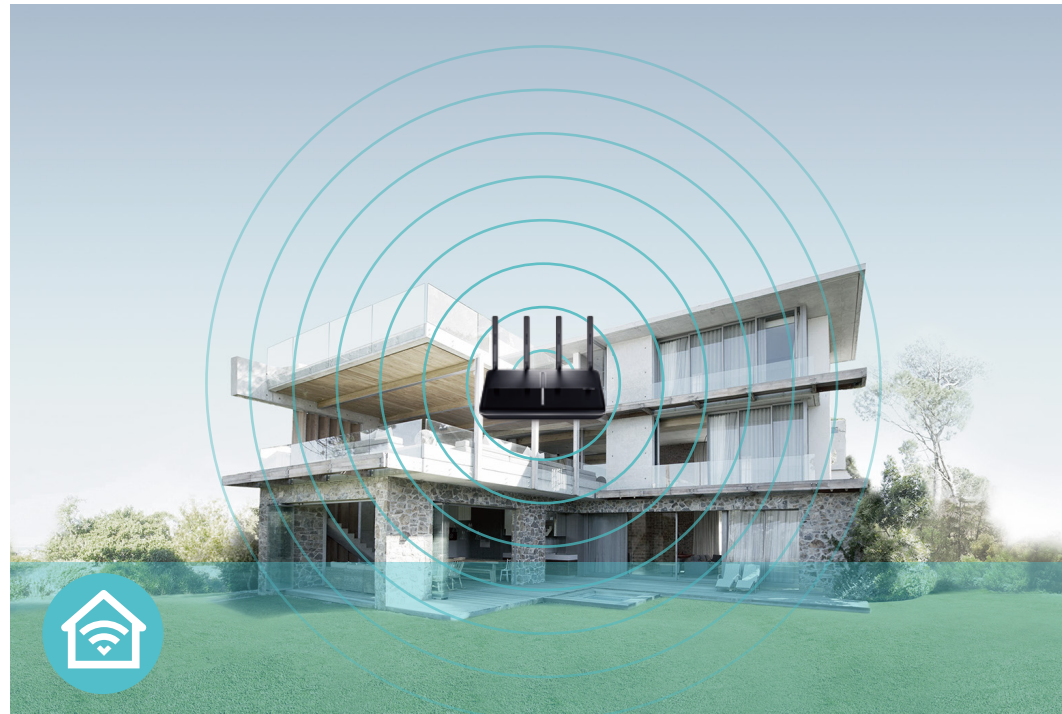

Wi-Fi Range

- **Ultimate Range Wi-Fi** – 4 dual band detachable antennas ensure widespread Wi-Fi coverage and a stable connection
- **Wi-Fi with Beamforming** – Beamforming technology locates the connected devices and further improves the Archer VR2800's range and the signal strength to each mobile device, delivering a more reliable and efficient wireless connection



Reliability

- **Simultaneous Dual Band** – Separate Wi-Fi bands enable more devices to connect to your network without a drop in performance
- **QoS** – Device/Application-based QoS makes it easier for you to prioritize the internet traffic

TP-Link AC2800 Wireless MU-MIMO VDSL/ADSL Modem Router **Archer VR2800**

Features



Ease of Use

- Intuitive Web UI – Ensures quick and simple installation without hassle
- Fast Connection – Connect wireless devices securely with the press of WPS button
- Easy On/Off – Turn On/Off power, wireless radio and LEDs separately using the Power On/Off, Wi-Fi On/Off and LED On/Off buttons
- Remote Management with TP-Link ID – Manage your home network from your smartphone or tablet via a single TP-Link ID, no matter where you find yourself
- Hassle-free Management with Tether App – Network management is made easy with the TP-Link Tether App, available on any Android or iOS device
- Online Upgrade – Keeps you informed of the latest firmware and allows online updating



Security

- Guest Network – Keep your main network secure by creating a separate network for friends and visitors
- Access Control – Establish a whitelist or blacklist to allow or block certain devices from accessing the internet
- Parental Controls – Manage when and how connected devices can access the internet
- VPN Server – OpenVPN, PPTP VPN and IPSec VPN are supported, making it easy to set up a secure connection between your private network and the internet
- Encryptions for Secure Network – WPA-PSK/WPA2- PSK encryptions provide active protection against security threats



Easy Sharing

- Dual USB Ports for Fast Sharing – With two ultra-fast USB 3.0 ports, you can access and share a printer as well as your files and media locally. Through the modem router's FTP server, you can also access your files and media from network devices remotely
- 10x Faster Transfer Speed – The USB 3.0 port provides up to 10x faster USB hard drive access than previous generation USB 2.0 connections
- Built-in Print Server – Allows wireless printing from multiple computers (works in conjunction with a USB printer)
- Built-in Media Server – Allows you to play music, watch videos and view photos from any device on your network

TP-Link AC2800 Wireless MU-MIMO VDSL/ADSL Modem Router Archer VR2800

Specifications

Hardware

- Ethernet Ports: 3 10/100/1000Mbps RJ45 LAN Ports, 1 10/100/1000Mbps RJ45 WAN/LAN Port, 1 RJ11 Port
- USB Port: 2 USB 3.0
- Button: WPS Button, Wi-Fi Button, Reset Button, LED On/Off Button, Power On/Off Button
- External Power Supply: 12V/3.3A
- Dimensions (W x D x H): 10.4 × 7.8 × 1.5 in (263.8 × 197.8 × 37.3 mm)
- IEEE Standards: IEEE 802.3, IEEE 802.3u, 802.3ab
- VDSL2 Standards: ITU G.993.2, Up to 17a profile (POTS)
ITU-T G.993.5 (G.vector)
ITU-T G.998.4 (G.INP)
- ADSL Standards: Full-rate ANSI T1.413 Issue 2,
ITU-T G.992.1(G.DMT),
ITU-T G.992.2(G.Lite),
ITU-T G.994.1 (G.hs),
- ADSL2 Standards: ITU-T G.992.3 (G.DMT.bis),
- ADSL2+ Standards: ITU-T G.992.5
- Antenna Type: 4 external detachable dual band antennas (RP-SMA)
- Antenna Gain: 3 x 2dBi for 2.4GHz and 4 x 3dBi for 5GHz

Wireless

- Wireless Standards: IEEE 802.11ac/n/a 5GHz, IEEE 802.11b/g/n 2.4GHz
- Frequency: 2.4GHz and 5GHz (Supports DFS)
- Signal Rate: 2167Mbps at 5GHz, 600Mbps at 2.4GHz
- Transmit Power: <20dBm (2.4GHz), <23dBm (5GHz Band1 & Band2), <30dBm (5GHz Band3)
- Wireless Function: Enable/Disable Wireless Radio, WMM, Wireless Statistics
- Wireless Security: 64/128-bit WEP, WPA/WPA2, WPA-PSK/WPA-PSK2 encryptions
- Wireless Schedule: Support 2.4GHz and 5GHz Wireless Schedule

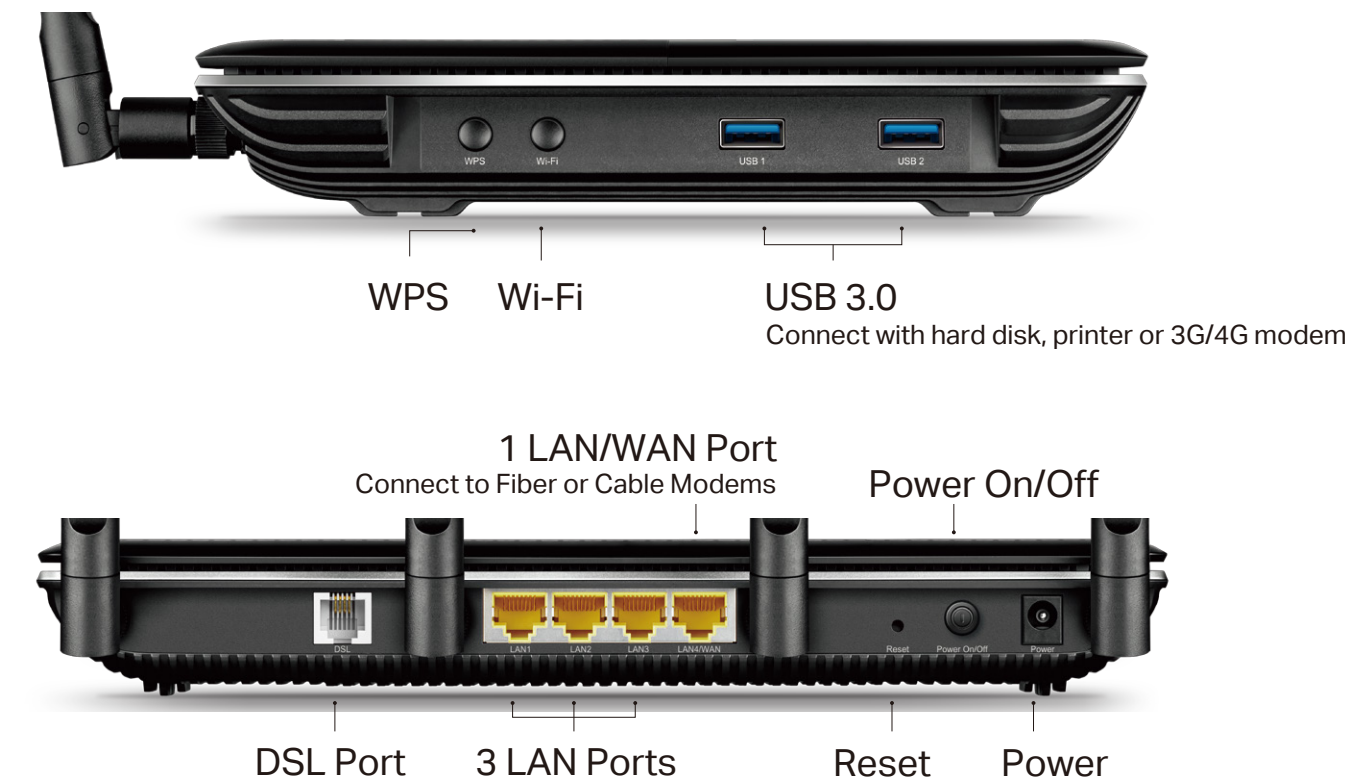

TP-Link AC2800 Wireless MU-MIMO VDSL/ADSL Modem Router Archer VR2800

Specifications

Software

- Operation Modes: VDSL/ADSL Modem Router, Wireless Router, 3G/4G Router
- DHCP: Server, Client, DHCP Client List, Address Reservation, DHCP Relay
- Quality of Service: ATM QoS, Traffic Control (IP QoS)
- Port Forwarding: Virtual Server, Port Triggering, DMZ, ALG, UPnP
- Dynamic DNS: DynDns, NO-IP, TP-Link
- VPN: OpenVPN, PPTP VPN, IPsec VPN
- ATM/PPP Protocols: ATM Forum UNI3.1/4.0, PPP over ATM (RFC 2364), PPP over Ethernet (RFC2516), IPoA (RFC1577/2225), MERIPoE (RFC 1483 Routed), Bridge (RFC1483 Bridge), PVC – Up to 8 PVCs
- Security: NAT Firewall, SPI Firewall, Access Control, Service Filtering, Denial of Service (DoS), SYN Flooding, Ping of Death, IP and MAC Address Binding
- Advanced Functions: Parental Controls, Network Address Translation(NAT), Port Mapping (Grouping), Static Routing, RIP v1/v2 (optional), DNS Relay, DDNS, IGMP V1/V2/V3
- USB Sharing: Support Samba (Storage) / FTP Server / Media Server / Printer Server, 3G/4G Modem / SFTP Server / Web Storage
- Management: Web Based Configuration (HTTP / HTTPS), Remote management, Command Line Interface, SSL for TR-069, SNMP v1/2c, Firmware Upgrade, Diagnostic Tools, Free Online Firmware Update
- Guest Network: 2.4GHz guest network, 5GHz guest network
- IPsec VPN: Support up to 10 IPsec VPN tunnels
- Protocols: Support IPv4 and IPv6



For more information, please visit

<http://www.tp-link.com/en/products/details/Archer-VR2800.html>

or scan the QR code left

Attention: This device may only be used indoors in all EU member states and EFTA countries. Specifications are subject to change without notice. TP-Link is a registered trademark of TP-Link Technologies Co., Ltd. Other brands and product names are trademarks or registered trademarks of their respective holders. Copyright ©2017 TP-Link Technologies Co., Ltd. All rights reserved.

Others

- Certification: CE, RCM, RoHS
- System Requirements:
 - Microsoft Windows 98SE, NT, 2000, XP, Vista™ or Windows 7, 8, 8.1, 10, Mac OS, NetWare, UNIX or Linux
 - Internet Explorer 11, Firefox 12.0, Chrome 20.0, Safari 4.0, or other Java-enabled browser
 - Subscription with an internet service provider (for internet access)
- Environment
 - Operating Temperature: 0°C~40°C (32°F ~104°F)
 - Storage Temperature: -40°C~70°C (-40°F ~158°F)
 - Operating Humidity: 10%~90% non-condensing
 - Storage Humidity: 5%~90% non-condensing
- Package Contents
 - AC2800 Wireless MU-MIMO VDSL/ADSL Modem Router Archer VR2800
 - External Splitter
 - RJ11 DSL Cable
 - RJ45 Ethernet Cable
 - Power Adapter
 - Quick Installation Guide

www.tp-link.com

TP-Link AC2800 Wireless MU-MIMO VDSL/ADSL Modem Router Archer VR2800



www.rxtx.com.au